

LPBA Series Up to 200W

Rugged, EMI Filtered, AC to DC Power Supply



Product Highlights:

- Low Profile, Compact Size
- > 0.99 Power Factor Correction
- On/Off Logic Control (Inhibit)
- Remote Sense compensates up to 0.5V
- Low Output Pk-Pk Noise Filter
- Mil-Std-461E Input EMI Filter
- Mil-Std-810 Environments
- Mil-Std-704A, Mil-Std-1399 Type I
- Over-Temperature Shutdown
- -40°C to +85°C standard operating temperature

General Specifications

	LPBA24	LPBA28	LPBA28-102	LPBA28-106 *Derate 50°C	LPBA28-107	LPBA28-108
Input Voltage	92-138VAC	92-138VAC	92-138VAC	187-253VAC	92-138VAC	92-138VAC
Frequency Range	47-63Hz	47-63Hz	47-63Hz	47-63Hz	380-440Hz	47-63Hz
Output Voltage	24VDC	28VDC	28VDC	28VDC	28VDC	28VDC
Output Current	8.25A	7.20A	7.20A	*7.20A-5.20A	7.20A	7.20A
Physical Size	0.96"H x 3.00"W x 6.00"L maximum (excludes connector mounting)					

Electrical Specifications

	LPBA24	LPBA28	LPBA28-102	LPBA28-106	LPBA28-107	LPBA28-108
Line Regulation (Lo Line to Hi Line)	24mV	28mV	28mV	28mV	28mV	28mV
Load Regulation (1/2-FL, w/ sense)	24mV	28mV	28mV	28mV	28mV	28mV
PARD(Ripple/Noise) DC- 20MHz	480mV	560mV	840mV	500mV	500mV	560mV
Overcurrent Setpoint	8.8-10.08A	7.75-9.50A	7.75-9.50A	7.92-9.36A	7.92-9.36A	7.70-9.50A
Short Circuit Current	7A-8.2A	6A - 7.2A	6A - 7.2A	3.6A - 5.1A	6A - 7.2A	6A - 7.2A
Overvoltage Set	25.2V-27.6V	30.7V-31.5V	29.75-31.5V	29.4V-32.2V	29.4V-32.2V	29.4V-32.2V
Load Step Recovery (1/2 to FL)	0.5mS	0.5mS	0.5mS	0.5mS	0.5mS	0.5mS
Turn-on Overshoot	<5%	<5%	<5%	<5%	<5%	<5%
Efficiency (min)	75%	75%	74%	75%	78%	75%
Isolation	> 100MΩ @ 500VDC, Input to Output and Input to Case; > 100MΩ @ 50VDC Output to Case					
EMI Filtering	Mil-Std-461E, CE101 and CE102 on the input, CS101, CS114, CS116, RE101, RE102, RS103					
Output Power	200W	200W	200W	200W	200W	200W

Temperature Specifications

Operating Baseplate Temperature	-40°C to +85°C
Storage Temperature	-55°C to +100°C
Temperature Coefficient	0.02%/°C

Note: Other output voltages and Environmental Screening also available. Please consult factory for details.



Arnold Magnetics Corporation, 841 Avenida Acaso, Camarillo, Ca 93012
Phone: 805/484-4221 Fax: 805/484-4113 Website: www.amcpower.com

Note: Specifications subject to change without notice.

Last Update: 09/07/06

LPBA Series

LPBA Series Up to 200W

LPBA Series

Environmental Specifications	
Pressure-Altitude	Per MIL-STD-810F, Method 500.4, Procedure I and II
High Temperature	Per MIL-STD-810F, Method 501.4, Procedure I and II
Low Temperature	Per MIL-STD-810F, Method 502.4, Procedure I
Humidity	Per MIL-STD-810F, Method 507.4, Procedure I
Fungus	Per Mil-Std-810F, Method 508.5, Procedure I
Salt Fog	Per Mil-Std-810F, Method 509.4, Procedure I
Sand and Dust	Per Mil-Std-810F, Method 510.4, Procedure I and II
Explosive Atmosphere	Per Mil-Std-810F, Method 511.4, Procedure I
Acceleration	Per MIL-STD-810F, Method 513.5, Procedure I and II
Vibration	Per MIL-STD-810F, Method 514.5, Procedure I, Category 1, 4, 7 thru 14 and 16 thru 21
Shock	Per MIL-STD-810F, Method 516.5, Procedure I, IV

Physical Characteristics	
Maximum Case Size	0.96"H x 3.00"W x 6.00"L max. (Excludes connector mounting)
Cooling Method	Conduction cooled through baseplate
Encapsulation	Clear RTV, GE615
Enclosure Finish	Black Anodized per Mil-A-8625F, Type II, Class 2
Baseplate Finish	Gold Iridite Mil-C-5541E, Class 1A
Input/Output Termination	15 Pin D-Sub Connector (See Pin-out Table below)
Mounting Holes - Standard Threaded Baseplate	Baseplate 6-32 UNC-2B THD x 0.22 Deep (6 places)
Weight	20 oz. typical

Outline and Mounting:

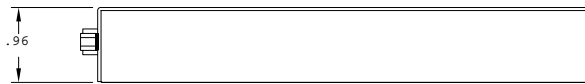
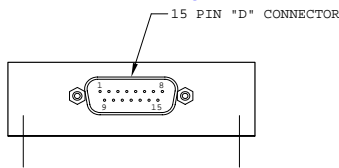

SIGNAL	PIN
AC LINE	1
SPARE	2
SPARE	3
N+1 SHARE	4
+SENSE	5
+28VDC OUT	6
+28VDC OUT	7
+28VDC OUT	8
AC NEUTRAL	9
CHASSIS GND	10
INHIBIT	11
-SENSE	12
-28VDC OUT	13
-28VDC OUT	14
-28VDC OUT	15

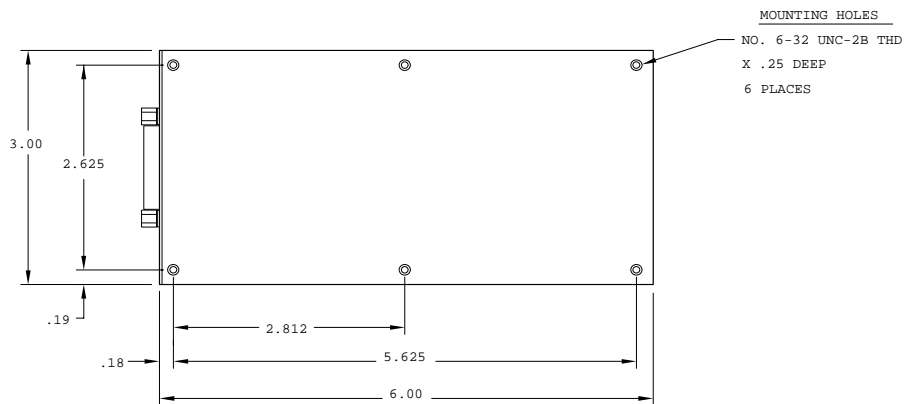

BOTTOM VIEW



Arnold Magnetics Corporation, 841 Avenida Acaso, Camarillo, Ca 93012
 Phone: 805/484-4221 Fax: 805/484-4113 Website: www.amcpower.com

Note: Specifications subject to change without notice.

Last Update: 09/07/06